

Thru-hole

FE-RR1

Reflector, round \varnothing 80.87 mm, central mounting hole



REF-H160

Reflector, rectangular 60 mm x 18 mm, mounting holes



REF-H32

Reflector, hexagonal 55 mm x 25 mm, mounting holes



REF-VR10

Reflector, rectangular 60 mm x 19 mm, mounting holes



Specifications

General specifications

Construction type	circular
Ambient conditions	
Ambient temperature	-20 ... 85 °C (-4 ... 185 °F)
Mechanical specifications	
Material	PMMA/ABS
Dimensions	Diameter: 80.87 mm
Mounting	mounting hole

Specifications

General specifications

Construction type	rectangular
Ambient conditions	
Ambient temperature	-20 ... 85 °C (-4 ... 185 °F)
Mechanical specifications	
Material	PMMA/ABS
Dimensions	60 mm x 18 mm x 8.3 mm
Mounting	mounting holes

Specifications

General specifications

Construction type	hexagonal
Ambient conditions	
Ambient temperature	-20 ... 60 °C (-4 ... 140 °F)
Mechanical specifications	
Material	PMMA/ABS
Dimensions	55 mm x 25 mm x 9 mm
Mounting	mounting holes

Specifications

General specifications

Construction type	rectangular
Ambient conditions	
Ambient temperature	-20 ... 85 °C (-4 ... 185 °F)
Mechanical specifications	
Material	PMMA/ABS
Dimensions	60 mm x 19 mm x 6 mm
Mounting	mounting holes

Dimensions in mm

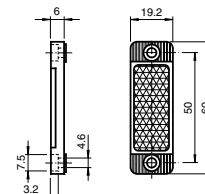
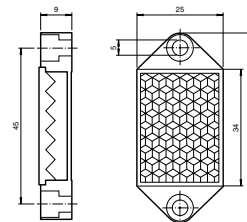
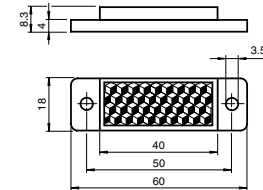
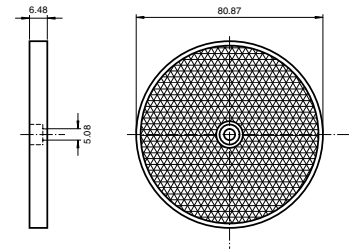

Thru-hole (cont.)

Dimensions in mm

REF-H50

Reflector, rectangular
50.9 mm x 50.9 mm, mounting holes,
fixing strap



Specifications

General specifications

Construction type rectangular

Ambient conditions

Ambient temperature -20 ... 85 °C (-4 ... 185 °F)

Mechanical specifications

Material PMMA/ABS

Dimensions 50.9 mm x 50.9 mm x 8.5 mm

Mounting mounting holes

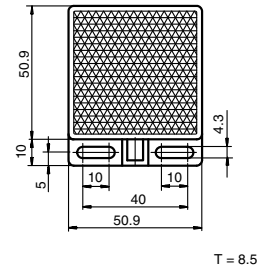

REF-H60

Reflector, rectangular
40.5 mm x 60 mm, mounting holes



Specifications

General specifications

Construction type rectangular

Ambient conditions

Ambient temperature -20 ... 85 °C (-4 ... 185 °F)

Mechanical specifications

Material PMMA/ABS

Dimensions 60 mm x 40.5 mm x 7.5 mm

Mounting mounting holes

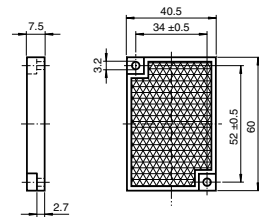

REF-H51x72

Reflector, rectangular 51 mm x 72 mm,
mounting holes



Specifications

General specifications

Construction type rectangular

Ambient conditions

Ambient temperature -20 ... 60 °C (-4 ... 140 °F)

Mechanical specifications

Material PMMA

Dimensions 51 mm x 72 mm x 7.5 mm

Mounting mounting holes

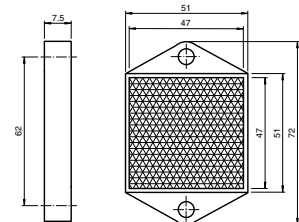

REF-H48

Reflector, rectangular
32.5 mm x 57 mm, mounting holes,
fixing strap



Specifications

General specifications

Construction type rectangular

Ambient conditions

Ambient temperature -20 ... 85 °C (-4 ... 185 °F)

Mechanical specifications

Material PMMA/ABS

Dimensions 32.5 mm x 57 mm x 8 mm

Mounting mounting holes

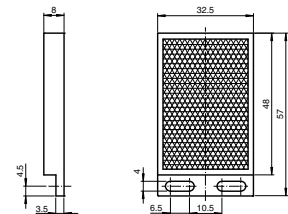

Thru-hole (cont.)

REF-H100

Reflector, rectangular
122 mm x 99.35 mm, mounting holes

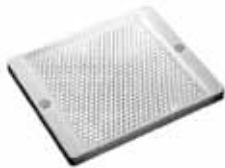

Specifications

General specifications	
Construction type	rectangular
Ambient conditions	
Ambient temperature	-40 ... 70 °C (-40 ... 158 °F)
Mechanical specifications	
Material	PMMA
Dimensions	122 mm x 99.35 mm x 8.5 mm
Mounting	mounting holes

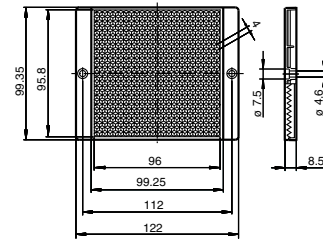

Dimensions in mm

REF-H180

Reflector, rectangular
180 mm x 40 mm, mounting holes



Specifications

General specifications	
Construction type	rectangular
Ambient conditions	
Ambient temperature	-20 ... 85 °C (-4 ... 185 °F)
Mechanical specifications	
Material	PMMA/ABS
Dimensions	180 mm x 40 mm x 7.4 mm
Mounting	mounting holes

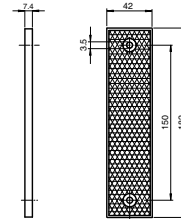

REF-H85-2

Reflector, rectangular
84.5 mm x 84.5 mm, mounting holes



Specifications

General specifications	
Construction type	rectangular
Ambient conditions	
Ambient temperature	-20 ... 85 °C (-4 ... 185 °F)
Mechanical specifications	
Material	PMMA/ABS
Dimensions	84.5 mm x 84.5 mm x 8.7 mm
Mounting	mounting holes

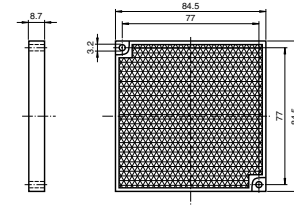

REF-H72

Reflector, rectangular 72 mm x 19 mm,
mounting holes

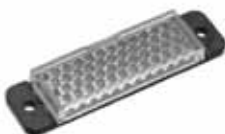

Specifications

General specifications	
Construction type	rectangular
Ambient conditions	
Ambient temperature	-20 ... 85 °C (-4 ... 185 °F)
Mechanical specifications	
Material	PMMA/ABS
Dimensions	72 mm x 19 mm x 8.5 mm
Mounting	mounting holes

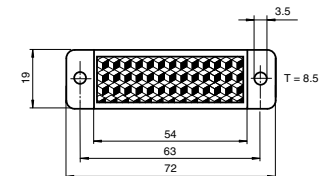

Thru-hole (cont.)

FE-RR15

Reflector, hexagonal 55 mm x 35 mm, mounting holes



Specifications

General specifications

Construction type circular

Ambient conditions

Ambient temperature -20 ... 60 °C (-4 ... 140 °F)

Mechanical specifications

Mounting mounting holes

Dimensions in mm

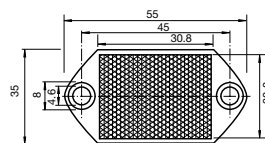

Threaded Stud

REF-S25

Reflector, round \varnothing 25 mm, screw fixing M4



Specifications

General specifications

Construction type circular

Ambient conditions

Ambient temperature -20 ... 85 °C (-4 ... 185 °F)

Mechanical specifications

Material PMMA/ABS

Dimensions Diameter: 25 mm

Mounting screw fixing

Includes M4 washer and nut.

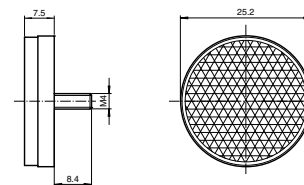

REF-S42

Reflector, round \varnothing 42 mm, screw fixing M5



Specifications

General specifications

Construction type circular

Ambient conditions

Ambient temperature -20 ... 85 °C (-4 ... 185 °F)

Mechanical specifications

Material PMMA/ABS

Dimensions Diameter: 42 mm

Mounting screw fixing

Includes M5 washer and nut.

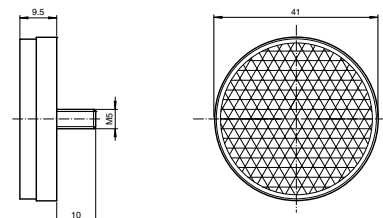

Self Adhesive

REF-A48

Reflector, rectangular 48 mm x 32.5 mm, self-adhesive



Specifications

General specifications

Construction type rectangular

Ambient conditions

Ambient temperature -20 ... 85 °C (-4 ... 185 °F)

Mechanical specifications

Material PMMA/ABS

Dimensions 48 mm x 32.5 mm x 8 mm

Mounting self-adhesive

